



M3

MS4003-S
MS4003-M
MS4003-L



ENGLISH USER MANUAL

ORIGINAL INSTRUCTIONS

CAUTION: READ THE INSTRUCTIONS BEFORE USING THE MACHINE



CONTENTS

Introduction	2 - 3	Charging Your M3 Battery	22 - 23
Technical Information	4 - 5	Electrical Connection	24
Safety Basics	6 - 7	Preparing Cleaning Solution	25
Know Your Equipment	8 - 9	Brush Holder & Brushes/Pads	26 - 27
Quick Start Guide	10 - 11	Brushes/Pads and Application	28 - 29
Where To Use M3	12 - 13	Cleaning with M3	30 - 31
Storing and Transporting Your M3	14 - 15	Underwater Use	32
Maintaining Correct Posture	16 - 17	Your Remote Support Team	33
Adjusting The Handle	18	M3/Backpack Assembly	34 - 35
PPE When Using M3	19	Declaration of Conformity	36
Battery Safety and Information	20 - 21	Your Warranty	37

**YOU MUST REGISTER YOUR MACHINE
TO ACTIVATE YOUR 3 YEAR WARRANTY**

Register your warranty at:
motorscrubberclean.com/warranty



EVERY BUILDING NEEDS AN M3. THIS IS YOURS.

We hope you experience exceptional results with your M3 machine. If you have any feedback, or need additional support, you can contact the MotorScrubber team at motorscrubberclean.com/support.

ABOUT THIS MANUAL

This manual contains all the information you need to get started with M3. Please read these instructions carefully.



CAUTION: This machine is for indoor use only

Technical Information



Say goodbye to manual scrubbing with M3. The M3 makes light work of deep cleaning confined and hard to reach places. Achieving outstanding cleaning results on any surface. Powerful, lightweight & battery operated.

M3 is intended for commercial use only. For example in hotels, schools, hospitals, factories, offices, shops and rental businesses.

Our manual has been designed to help you safely and effectively get started with M3. It includes technical instructions and guidance on how to set up and operate your machine, in addition to storage and maintenance.

We've used symbols throughout our manual to draw your attention to important safety guidance, features and information. Here is an overview of what each symbol means.

PRODUCT LABEL EXPLANATION

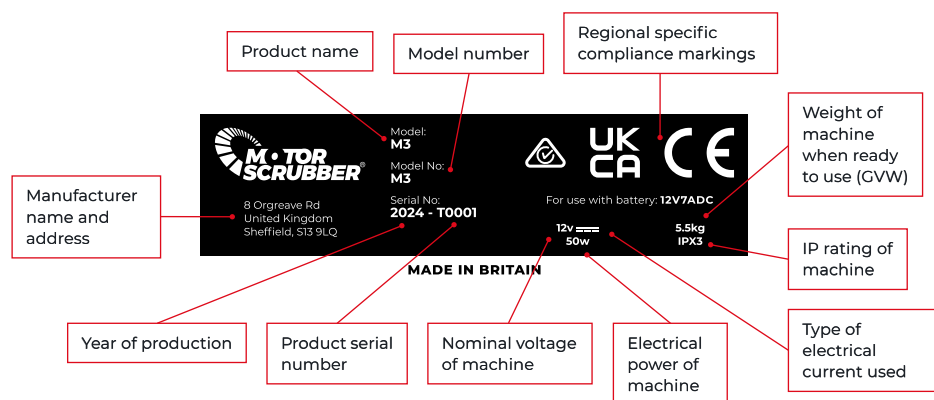

WARNING SYMBOLS



DANGER: Indicates an imminent dangerous situation that, unless avoided, will result in death or serious injuries



WARNING: Indicates a potentially dangerous situation that, unless avoided, could cause death or serious injury



CAUTION: Indicates a potentially dangerous situation that, unless avoided, could cause slight or moderate injuries



Information: Indicates additional information for the operator, to improve the use of the device

OTHER SYMBOLS



Open book symbol with an "i": Indicates the need to consult the instruction manual



Open book symbol: Tells the operator to read the user manual before using the device



Wear Safety Footwear: To signify that safety footwear must be worn



Wear Protective Gloves: To signify that protective gloves must be worn



Wear Eye Protection: To signify that eye protection must be worn



Disposal Symbol: Information regarding the correct means for disposing the appliance



International Recycling Symbol



Ventilation: Specific function should only be performed in a well-ventilated environment



For Indoor Use Only: To identify electrical equipment designed primarily for indoor use



Disconnect Power: Disconnect the power between the battery and the cleaning head

Safety

Basics

M3 is incredibly safe and easy to use. However, as it is an electrical product we need to make you aware of some important safety information.

By following the advice on this page, you can reduce any risk of electric shock and personal injury.



DANGER: Do not operate in the presence of explosives, or flammable fumes or liquids. Ensure any chemicals you use are non-flammable



DANGER: M3 is powered by DC current only. Do not attempt to operate M3 with AC current



DANGER: Never attempt to operate M3 from an electrical outlet. It should only be powered by the 12-volt battery



DANGER: Consider your work area environment. When using M3 be aware of overhead electrical wires



WARNING: When changing accessories or undertaking maintenance on M3, you should always disconnect the machine from the battery



CAUTION: M3 is a power tool. Although it is safe to operate with one hand during operation, you should operate with both hands when switching the machine on and off



M3 is designed to be used by experienced and knowledgeable cleaning professionals over the age of 18. It must not be used by children or anyone with a physical, mental or sensory impairment which could make using M3 unsafe



Your MotorScrubber M3 must be kept clean to ensure safe operation. The upper handle and switch area should be dry, and the machine should be clean and free from oil, grease and water when not in use



Always follow instructions for attaching accessories.
(For Brush Holder see page **26-27**, for Brushes and Pads see page **28-29**)



Keep product cords and wires away from heat, oil and sharp edges



Ensure you adopt the correct posture when using M3. Adjust the position of the handle (see page **16-17**) so your arm is straight, allowing you to maintain a straight back



WARNING: All operators should be adequately instructed on the use of this machine

Know Your Equipment



M3

1. Handle Grip
2. Switch Housing
3. Handle Flip Clip 32mm
4. Locking Knob
5. Acorn Nut
6. Hub
7. Motorhead
8. Thumb Screws
9. Aluminium Tube
10. Handle
11. 3-Pin Connector



BACKPACK

1. Carry Handle
2. 3 Pin Connector
3. Cable Tidy and Holster
4. Battery Pack

BACKPACK: The backpack should be put over your shoulders like a backpack. There are two adjustable straps, which can be pulled to tighten the shoulder supports to a comfortable user level. Ensure the hook and loop belt strap is fastened across your abdomen.

ACCESSORIES

5. Green Scrubbing Pad
6. White Buffing Pad
7. Microfibre Pad
8. Red Polishing Pad
9. Medium Dry Brush
10. Charger



WARNING: Always inspect M3 for damage before use

Quick Start Guide



Charge battery (page **22-23**)



Put on the backpack



Adjust straps



Attach/remove the Brush Holder and add/change M3 brush/pad (page **28-29**)



Connect electrics (page **24**)



Adjust handle length (page **18**)



Clean with M3 (page **30-31**)

Where to use **M3**



Kitchen Cleaning



Walls



Stairs



Floor Cleaning



Swimming Pools



Textured Surfaces

Storing and Transporting

Your M3

M3 has been designed to be safe and easy to transport when following the below safety advice.

MACHINE TRANSPORTATION

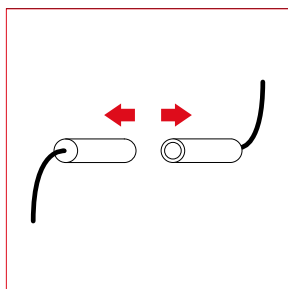

Disconnect the power
connection between the
battery and the M3 (see
page **22-25**)



CAUTION: Secure the machine when transporting in a vehicle to prevent damage to the machine

M3's compact design means that it is easy to store. We recommend using a wall dock or M-CASE for proper storage. However you choose to store your M3, you should follow the below guidance.

MACHINE STORAGE

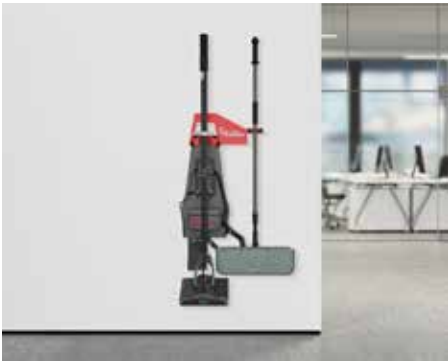

 WALL DOCK



 M-CASE PRO



If the appliance is to be stored unused for a long period, the battery backpack should be disconnected from the machine via the cable connector. Alternatively, the battery can be removed from the backpack



WARNING: When storing or carrying batteries, always ensure that they cannot come into contact with any metal objects. This could result in the battery short circuiting, causing fire, personal injury or damage to the battery



WARNING: The battery and charger must never be used or stored in outdoor environments, or in damp conditions



CAUTION: This machine should be stored indoors only

Maintaining Correct Posture





According to a joint study by UNISON and the Health and Safety Executive, 20% of cleaners using floor cleaning machines need time off work because of aches and pains. We've designed our GEN3 Battery Backpack and M3 to be ergonomic and easy to use, reducing the risk of strains and injury.

Your backpack should be correctly worn and adjusted before using your machine. Each time you wear the backpack you should adjust the shoulder straps and secure the waistband.

Ensure you adopt the correct posture when using M3 and maintain a straight back.

Adjust the position of the control handle so your arm is straight when holding the handle. Your back should be straight at all times.

RULES TO FOLLOW

- **Your backpack should be correctly worn and adjusted before using your machine**
- **Each time you wear the backpack you should adjust the shoulder straps and secure the waistband**
- **Ensure you adopt the correct posture with a straight back when using M3. Let M3 do all the work**

Adjusting the Handle



ADJUSTING THE HANDLE LENGTH

Release the black clip by pushing up the release catch. (1) Adjust the pole to your desired length, then push the black clip back into position. Do not extend further than the red stop line printed on the handle.

If the telescopic pole is slipping while in use, you will need to ensure the clip

is tightened appropriately. To do this, locate the green adjustment screw (2) and ensure the black clip is in an open position.

Being careful not to over tighten, turn the screw clockwise (3) until you can comfortably push the black clip back into its lock position. If the black clip

is difficult to push back, turn the green screw anti-clockwise until it is easy to push back into position. For an instructional video please visit:

www.motorscrubberclean.com/support

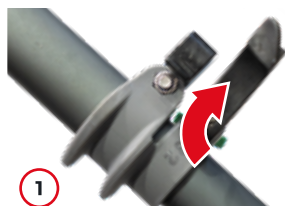

HANDLE POSITION

The Control handle is pre set to the optimum position and we don't recommend changing this. However, if you do wish to change the handle position it can be done by following these simple steps.

1. Turn the M3 over so the back of the handle is facing you.
2. Using a Phillips screwdriver, remove the two screws and take off the handle base.
3. Move the handle to your desired position, replace the handle base and screws.



PPE when using M3

GENERAL USAGE

When operating M3 you should always wear safety footwear, which is well gripped. If you're cleaning with water only, no additional PPE is required. However, if you're using disinfectant or chemical, you should always follow the manufacturer's PPE advice.



Wear safety footwear whilst operating and servicing M3

USING CHEMICALS

For more information on using chemicals with M3, see page **25**.

Please check your chemical's MSDS sheet, which will give clear instructions of PPE required when using their product.

If unsure, contact your chemical manufacturer. Explain how many hours of usage you will be using the product for. They can then recommend what PPE to wear to protect yourself.





Ensure that you follow your chemical manufacturers advice on the need for additional PPE, such as protective gloves and eye protection

Battery safety and information

M3 is powered by either a 12-volt sealed lead acid battery OR a 12 volt Lithium Ion Battery. More information on the battery run time and charging can be found on page **22-23**.

Only use the battery charger provided with your M3 to ensure it is charged safely.

BATTERY	CHARGER	LABEL COLOURS
Lead Acid Battery (12V7ADC)	(MS1580(A, B, C))	
Lithium Ion Battery (12V18ADC)	(MSCHARGLITH(6AMP))	

Operating the machine on an empty battery could cause permanent damage to it. Charge or swap batteries as soon as the battery has depleted.

We recommend having spare batteries to hand.



DANGER: Do not disassemble, heat above 122°F (50°C), or incinerate the battery. Risk of fire, explosion, or burns



WARNING: Never attempt to open a battery for any reason. If the housing of the battery breaks or cracks, immediately discontinue use and do not recharge. The battery should be replaced



WARNING: Do not charge a battery if it is wet or shows any evidence of corrosion



WARNING: Do not incinerate the battery; it can explode in a fire



WARNING: Plug the battery charger directly into a 120VAC/60HZ or 240VAC, with the correct plug adaptor, electrical outlet (Do not use an extension cord)



CAUTION: In the unlikely event of battery leakage, wash eyes and skin with water if contact is made with acid and seek medical advice immediately

BATTERY HANDLING

If it is suspected that free electrolyte is present, then safety glasses must be worn, and if large amounts are present, chemical goggles or face shield should be used.



WARNING: Harmful if swallowed



WARNING: Keep out of the reach of children



WARNING: Don't immerse, throw, wet the battery in water



WARNING: Don't short circuit (+) and (-) terminals with metallic object intentionally



CAUTION: If it is suspected that free electrolyte is present, then safety glasses must be worn, and if large amounts are present, chemical goggles or a face shield should be used



CAUTION: Remove ALL metallic objects from the person when working with batteries. This includes jewellery (rings, bracelets, necklaces), watches, pens, torches, etc. Don't store the battery in a pocket or a bag together with metallic objects



CAUTION: Where there are signs of damage or liquid (electrolyte) or solid deposits, rubber gloves and acid resistant clothing must be worn when handling the batteries and affected packaging to protect against the effects of any electrolyte that may be present



FUSE PROTECTION: M3 is equipped with a 15 AMP replaceable fuse to protect against short circuit. This fuse can be found inside the battery compartment



The green wire used within this system is a low voltage power return from the pump switch

Important Information

CHARGING YOUR M3 BATTERY

Your M3 battery (12V7ADC) is a rechargeable sealed lead-acid battery (VRLA). It can be charged two ways:

In-backpack

Connect your battery (12V7ADC) to your charger (MS1580(A, B, C)) whilst fitted into your backpack using the charging port on the left side of the battery compartment.



If you have 2 pin-connector charger

As a spare battery

Connect your battery (12V7ADC) to your charger (MS1580(A, B, C)) using the charger adapter (MSS228).



Connect your battery (12V7ADC) to your charger (MS1580(A, B, C)) whilst fitted into your backpack using the 3-pin coiled cable (MS3009D) on the right side of the battery compartment.



If you have 3 pin-connector charger

Connect your battery (12V7ADC) to your charger (MS1580(A, B, C)) using the charger adapter (MSS228B-3PIN).



Always plug your charger directly into a 120 VAC/60HZ or 240 VAC electrical outlet, or use an adapter or charger for the AC source being used (do not use an extension).



WARNING: Only use the supply unit (MSI580, MLF-012W1201000) provided with this appliance to charge the battery (12V7ADC)



WARNING: Do not charge VRLA Batteries above + 50 °C, discharge or store above + 60 °C

For best results, do not charge a battery when the battery or air temperature is below 40°F (5°C) or above 105°F (40°C). When charging the machine the red light will show, when the battery is fully charged the light will show green.

After charging, disconnect the charger from the AC outlet and (IMPORTANT) disconnect the charger from the battery.



CHARGING



CHARGED



ATTENTION: The space used for charging the battery must be adequately ventilated

Important Information

CHARGING YOUR M3 LITHIUM BATTERY 12V18ADC

Your M3 battery 12V18ADC is a rechargeable Lithium Ion Battery. It can be charged two ways:

In-backpack

Connect your battery (12V18ADC) to your charger (MSCHARGLITH(6AMP)) whilst fitted into your backpack using the charging jack on the wiring harness on the top of your battery.

As a spare battery

Connect your battery (12V18ADC) to your charger (MSCHARGLITH(6AMP)) using the charging jack on the wiring harness on the top of your battery.

Always plug your charger directly into a 120 VAC/60HZ or 240 VAC electrical outlet, or use an adapter or charger for the AC source being used (do not use an extension).

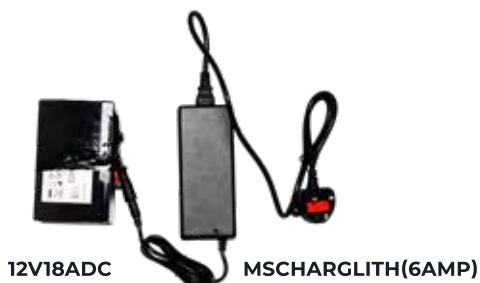

BATTERY PERFORMANCE

Batteries should be charged **before using your M3**, after each use and if unused for four months.

Battery Type	A full charge from flat	Run Time (full charge)
Lead Acid Battery (12V7ADC)	Approx 4 hours	Approx 3.5 hours
Lithium Ion Battery (12V18ADC)	Approx 3 hours	8 hours

* Different floor and pad types may reduce run time.

If you require long periods of machine use, we recommend you also order spare batteries. When ordering 12V18ADC as a spare battery, you should also order the MSCHARGLITH(6AMP) charger.

When ordering 12V7ADC as a spare battery, you should also order the MSS228 charging adapter and MS1580(A, B, C) charger.

Important Information

ELECTRICAL CONNECTION

The machine connects to the backpack using a quick fit stainless steel electrical connection. Simply line up the red dots and push until you hear a click. To release the connection, grip the textured areas and pull apart.



CAUTION: Before you connect the power cable, check the machine is not on. The red switch operates the brush head. This is a latching switch, depress the switch until you hear a click and let go, the motor will run continuously. Press again and this will stop the brush. It is important that this button is not depressed before you connect the electrics



PREPARING CLEANING SOLUTION

M3's powerful agitation and latest pad technology will clean floors using just water. Some cleaning challenges may require chemical. For example use a degreaser for removing grease or oil, and use a descaler for removing scale build up in bathrooms and pool areas.

It is very difficult for us to approve every chemical on the market, however the majority of cleaning detergents are safe to use with your MotorScrubber backpack. If you do use some very harsh chemicals, it is possible that the life expectancy of some components will be reduced, such as the pump membrane, check valve and water-pipe. These components are all replaceable at affordable costs. Using some harsh chemicals may result in more frequent servicing.



WARNING: Ensure current regulations concerning safe transportation of dangerous substances are followed



WARNING: Do not use flammable chemicals or solutions

Important Information

BRUSH HOLDER AND BRUSHES/PADS

The M3 is compatible with a wide range of pads and brushes, designed for a wide variety of uses. These additions are attached and removed with a simple rotating lock system. Please follow the step-by-step guide.

For effective use of the M3, adhere to the following steps to guarantee a seamless operation and superior cleaning results:

Position the brush or pad to be completely level with the floor surface. This alignment is crucial for smooth functioning of the M3 and to achieve the highest level of cleanliness.

Before beginning the scrubbing process, apply a cleaning agent to the pad or brush by using a sprayer to coat the surface or by directly applying the solution onto the scrub disc. Alternatively, you can prepare a mixture of soap concentrate in a bucket and immerse the scrub head in the solution.

Begin scrubbing and use uniform, light strokes. The M3 is designed for rigorous work but only requires application of mild pressure in areas requiring extra attention - let M3 do the hard work for you.



WARNING: ALWAYS disconnect the power between the backpack and M3 before adding or removing the brush holder or cleaning pads & brushes



WARNING: Ensure fingers are kept clear of M3's rotating mechanism



WARNING: Only use cleaning pads & brushes which have been specifically designed and recommended for the M3. We cannot guarantee the safety of any other cleaning brushes or pads

CHANGING M3 BRUSHES

1. Turn the MotorScrubber upside down and support the handle with the inside of your foot.
2. Line-up the tabs on the disc with the hub on the MotorScrubber.
3. Hold the hub firmly to prevent rotation. Press down while turning the disc clockwise until it locks in place.
4. To remove, press down on the disc and turn it counter clockwise holding hub until tabs are free. Then lift off the disc.



REMOVING DIRTY SLURRY

There are many ways to remove dirty slurry after cleaning, the most effective ways are:

1. MotorScrubber can be equipped with a suction head, which can be connected to a wet vac for instant slurry pickup.
2. Squeegee - Many hard floor areas have a drain in the floor. Dry and remove the slurry with your Blade floor squeegee into the drain.
3. Attach BLADE A-Fibre and dry.



A-Fibre

- Absorbs 500ml/0.13ga of liquid.
- Absorb Spills & Dry Floors.

Brushes/Pads and Applications

M3 is supplied with five pads/brushes, each with specific features and applications.



MEDIUM DUTY BRUSH

Non scratch fibres provide a brilliant deep clean to all smooth and textured floors and tiles.

Application: Versatile pad suitable for cleaning all floor types.

Reusable: This pad should last three to six months.



GREEN SCRUBBING PAD

For cleaning greasy kitchens and floors. This pad aggressively removes dirt from heavily soiled surfaces.

Application: For daily maintenance on most floor types between deep cleans.

Reusable: Wash up to 300 times.



WHITE BUFFING PAD

For buffing on hard floors. Use dry or with a fine water mist to give a high gloss wet look to new floors.

Application: For daily maintenance on most floor types between deep cleans.

Reusable: Wash up to 300 times.

BRUSH/PAD CLEANING

1. Remove Brush Holder (See page 27)
2. Remove cleaning brush or pad from the Brush Holder
3. For disposable brushes/pads – dispose in accordance with local environmental regulations
4. Washable brushes/pads can be cleaned using the instructions provided on the pad labelling

MICROFIBRE PAD



Recommended for polishing surfaces and for carpet spot cleaning.

Application: Versatile pad suitable for cleaning all floor types.

Reusable: This pad should last three to six months.

RED POLISHING PAD



For polishing hard and wooden floors. This will remove light scuff marks and dirt while giving a high gloss shine.

Application: For daily maintenance on most floor types between deep cleans.

Reusable: Wash up to 300 times.



CAUTION: Only use cleaning brushes & pads which have been specifically designed and recommended for M3. We cannot guarantee the safety of any other cleaning brushes & pads

Cleaning with M3



- When using MotorScrubber make sure the brush or pad is flat to the floor, this will ensure smooth operation of the machine and an optimal clean.
- Apply soap/cleaning solution to the surface with a sprayer or directly to the scrub disc. You may also mix soap concentrate in a bucket and dip the scrub head into the bucket.
- Scrub with straight, light strokes. You can exert light pressure where needed, let MotorScrubber do the hard work for you.

DO NOT USE MOTORSCRUBBER WITH FLAMMABLE CLEANING FLUIDS

FUSED PROTECTION

MotorScrubber is equipped with 15Amp replaceable fuse, to protect against short circuit. This fuse can be found inside the battery compartment.



SLIP HAZARD: M3 utilises water and/or cleaning solution on the floor, creating a potential slip hazard. Ensure appropriate PPE footwear is worn (See page 19)



SLIP HAZARD: M3 is intended for commercial use. Ensure others are alerted to the potential slip hazard by using appropriate signage

REMOVING DIRTY SLURRY

There are many ways to remove dirty slurry after cleaning, the most effective ways are:

1. Many hard floor areas have a drain in the floor. Dry and remove the slurry with your BLADE floor squeegee into the drain.
2. Attach BLADE A-Fibre and dry. Each A-Fibre holds 500ml of liquid. Wash A-Fibres after use.



PRODUCT FAULT INDICATION

You should inspect your M3 for damage before each use. This is especially important if you are using M3 as part of a larger cleaning team.

The battery charger supply (type Z connector) cord cannot be replaced. If the cord is damaged, the battery charger should be scrapped. Please contact the manufacturer/distributor for a replacement unit.



ATTENTION: Do not use the M3 if it appears damaged or faulty



Exhausted batteries are to be removed from the appliance and safely disposed of in an environmentally friendly manner in accordance with local national laws and regulations

Underwater Use

- Because its motor head can be fully-immersed in water, the MotorScrubber is ideal for many underwater cleaning tasks. One of the more popular uses of the MotorScrubber is cleaning the “scum line” above the water level in swimming pools, spas, boats, etc.
- Immersing the head for long periods of time could effect its water-proofing seals, due to the effects of prolonged heating, cooling and chlorine. The seals could contract and allow water to make direct contact with the motor, which would cause a motor failure. Guidelines need to be followed to avoid this.
- If the unit is used underwater on a regular basis, an internal inspection of the head is also required each month by a competent technician, this is to check for water ingress.

WE RECOMMEND NOT USING THE MOTORSCRUBBER FULLY SUBMERGED IN WATER FOR MORE THAN 2 MINUTES CONTINUOUSLY. MOTORSCRUBBER SHOULD THEN BE REMOVED AND ALLOWED TO COOL FOR 5 MINUTES.

- Waterline cleaning, where MotorScrubber is half in and half out of the water there is no limitations.
- Regular underwater usage will reduce the lifetime of the head unit. MSGREY12V complete motor head can be purchased and replaced when required. 1 year is the suggested life of regular underwater use.



Fully submerged Use
for 2 minutes then take out to cool for 5 minutes.

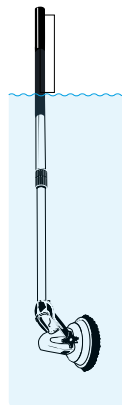

Submerge up to 25cm away from the switches.

Scum line cleaning

There are no limitations, you can clean continuous using this method.

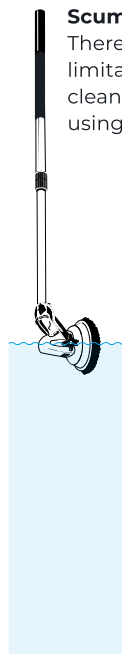



YOUR REMOTE SUPPORT TEAM

M3 is manufactured and assembled at our headquarters in Sheffield, UK, by a team of skilled assembly technicians.

Working closely with our design and engineering team, they know each one of our machines inside out, which means they are best placed to assist you in the rare instance you experience a product fault.

If you need technical support you can contact us at www.motorscrubberclean.com/support.

Our team are typically able to resolve faults remotely, guiding you through undertaking the repairs yourself. Sometimes they may ask you to take a video of your machine's fault so they can be certain they are giving the correct advice.

Please don't void your warranty by attempting to resolve a product fault without proper guidance from one of our technicians. For more information on our warranty, see page 39.



M3 Assembly

1. **MS3003R** ALUMINIUM TUBE
2. **MS3004C** GRAB HANDLE
3. **MSS103** RUBBER GRIP
4. **MSS402D-3PIN** SWITCH HOUSING
5. **MS1041** MEDIUM DUTY BRUSH
6. **MSS172B** THUMB SCREW
7. **MSGREY12** MOTORSCRUBBER MOTORHEAD COMPLETE GREY WITH YOKE
8. **MSS032** HANDLE FLIP CLIP 32MM

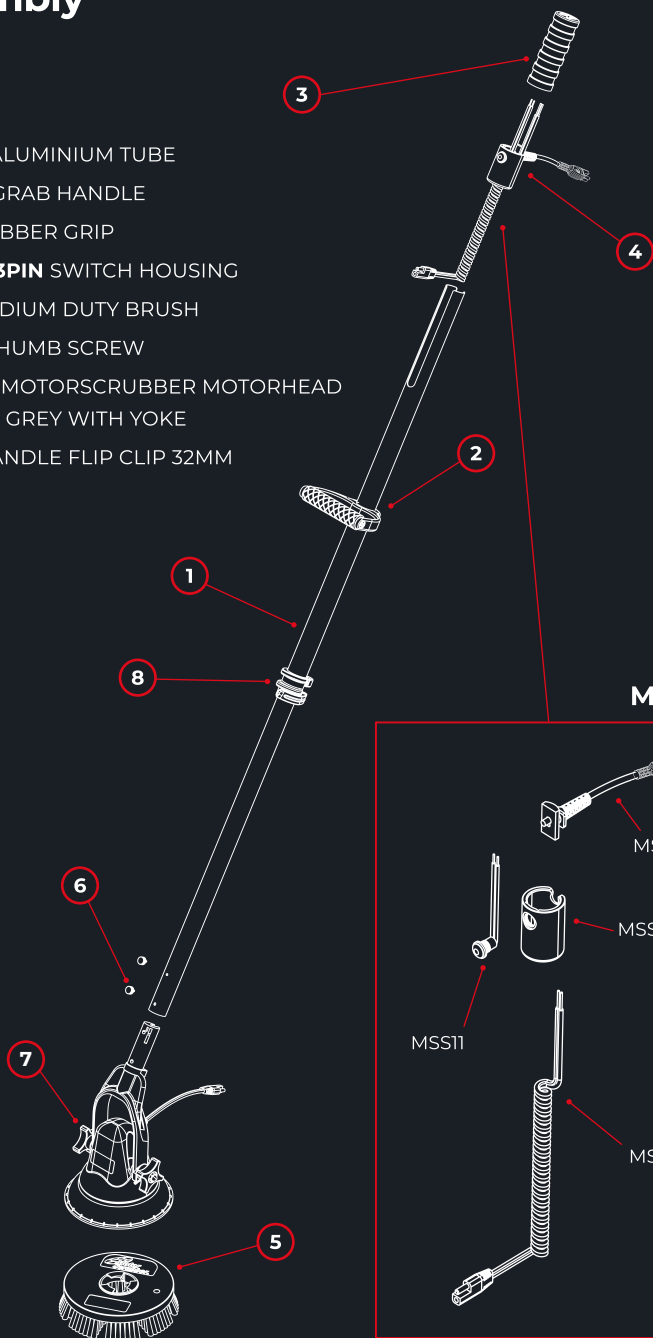

MSS402-D

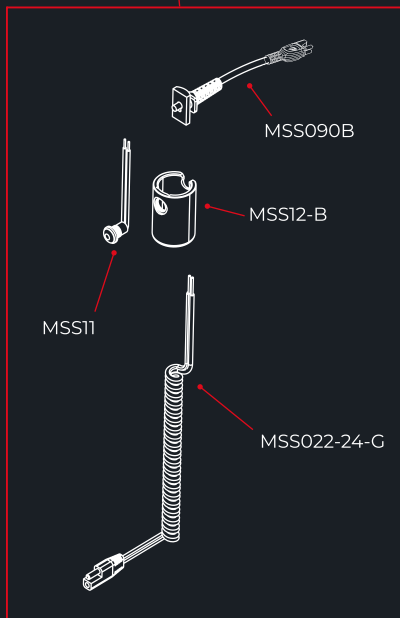

Backpack Assembly

1. **MSS02-B BACKPACK**
2. **12V7ADC/12V18ADC BATTERY**
3. **MS3009D COILED CABLE**
4. **MSI580/MSCHARGELITH(6AMP) BATTERY CHARGER**
5. **MSPAUK/US/AU/EU REGIONAL SPECIFIC PLUG ADAPTOR FOR CHARGER**

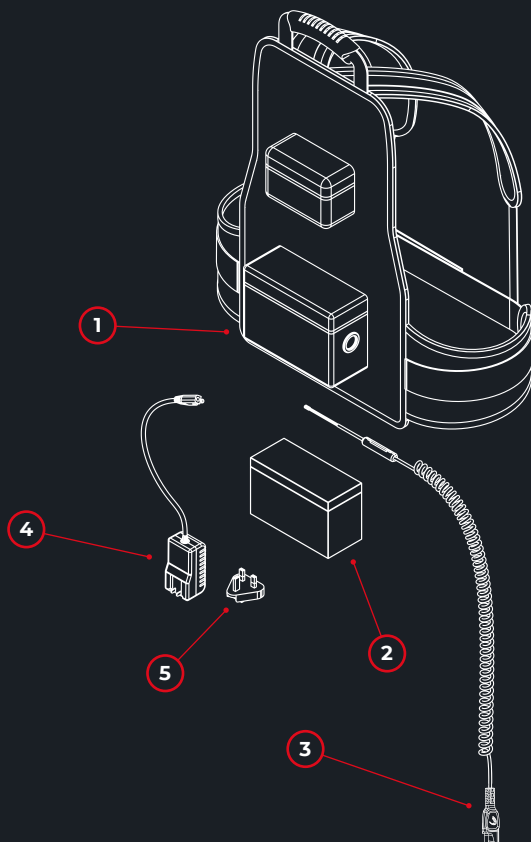



Declaration of Conformity

07/08/2023

The following products have been reviewed by MotorScrubber Ltd and external testing partners to ensure compliance with the applicable directives & standards.

Applicant: MOTORSCRUBBER Limited

Address: 8 Orgreave Road, Sheffield, S13 9LQ, United Kingdom

Product: MotorScrubber Battery Operated Cleaning Machine.

Model no(s): M3S, M3M, M3L, MSJET, MSPROWASH, MSSHOCK, MSSTORM

Rated Input: AC 100 – 240Volt~, 50/60Hz, 0.6Amp

Rated Output: DC 12 Volt, 7Ah

Model No: MSFORCE

Rated Output: DC 24 Volt



Conforms to:

Supply of Machinery (Safety) Regulations 2008
Electrical Equipment (Safety) Regulations 2016
Electromagnetic Compatibility Regulations 2016

Designated Standards

EN60335-1, EN60335-2-72, EN60204,
EN55014-1, EN55014-2

Conforms to:

Machinery Directive 2006/42/EC
Low Voltage Directive 2006/95/EC
EMC Directive 2004/108/EC

Harmonized Standards

EN60335-1, EN60335-2-72, EN60204,
EN55014-1, EN55014-2

The product technical Construction Files are held at the above address, this includes the supplied A.C. Charging Adapter.

Yours Sincerely

Imre Killi – CEO

Signed: *Imre Killi*

Date: *07/08/23*

**TRANSFORM
THE WAY
YOU CLEAN**

HEAD OFFICE

8 Orgreave Rd, Sheffield, S13 9LQ, England
+44 (0)114 478 8710 / orders@motorscrubberclean.com

USA

+1 630 326 3107 / usaorders@motorscrubberclean.com

AUSTRALIA

+61 499 269 988 / aussorders@motorscrubberclean.com



Company Reg: 1027714 / VAT No: 318 1540 39

Your Warranty

LIMITED THREE-YEAR WARRANTY MotorScrubber M3

ONE YEAR COMMERCIAL WARRANTY AS STANDARD. THREE YEAR COMMERCIAL WARRANTY AFTER REGISTERING YOUR M3.

M3 is built to withstand the challenges of commercial cleaning, using high quality components that are tested to their limits. Each machine is assembled and quality inspected at our Sheffield HQ, and no machine passes through our doors without meeting our rigorous standards.

We're so confident in the quality of our products that we offer a three-year commercial warranty on all registered machines**, for complete peace of mind and worry-free cleaning.

If your machine encounters any issues, our helpful team aim to get you back up and running in the shortest possible time.

Most faults can be rectified remotely, so should any problem covered by this warranty develop during the three-year period, please send a photo or video of the fault to warranty@motorscrubberclean.com and our warranty team will guide you in your repair.

If the fault cannot be rectified remotely then follow the instructions in this booklet and return the unit, carefully packaged with freight prepaid to your original supplier.

Your supplier will inspect the item and liaise with us directly. If inspection shows the problem was caused by a defect in workmanship or materials, your supplier will repair (or at our joint option, replace) the unit without charge, return freight prepaid.

PLEASE DON'T VOID YOUR WARRANTY BY:

1. Making alterations to the product.
2. Repairing or attempting to make repairs by anyone other than an authorised MotorScrubber agent, unless guided remotely.
3. Mistreating, misusing or improperly maintaining or operating the product.
4. Using non-genuine floor pads.

YOU MUST REGISTER YOUR MACHINE TO ACTIVATE YOUR 3 YEAR WARRANTY

Register your warranty at:
motorscrubberclean.com/warranty



*Terms and conditions may vary depending on your country, please contact your local supplier for exact terms.

**Our standard warranty is 1 year if it isn't registered with us.



**YOU MUST REGISTER
YOUR MACHINE TO
ACTIVATE YOUR
3 YEAR WARRANTY**

Register your warranty at:
motorscrubberclean.com/warranty

HEAD OFFICE

UK

8 Orgreave Rd, Sheffield,
S13 9LQ, England
+44 (0)114 478 8710
orders@motorscrubberclean.com

info@motorscrubberclean.com
www.motorscrubberclean.com

INTERNATIONAL

USA and Canada - Chicago

+1 630 326 3107
usaorders@motorscrubberclean.com

AUSTRALIA - Melbourne

+61 459 269 988
ausorders@motorscrubberclean.com